



# 2003-1997 Ford Trucks - 4WD & 2WD

## Improved Design

1. X-Factor designed with oversized high strength steel ball stud. 15% increase in size over OEM, increased hardness for metal-to-metal contact, and black oxide coating for better corrosion resistance allowing for increased service life.
2. Greasable Ball joint for increased service life. Ball joint is removable.
3. X-Factor designed with:
  - a. Increased thickness throughout control arm assembly, 20% more rigid than OE.
  - b. Increased thickness at ball joint socket.

4WD	F-150, F-250 & Expedition	MK8722T
		MK8724T
2WD	F-150, F-250 & Expedition	MK8726T
		MK8728T
4WD 2WD	F-150, F-250, & Expedition	MK80014

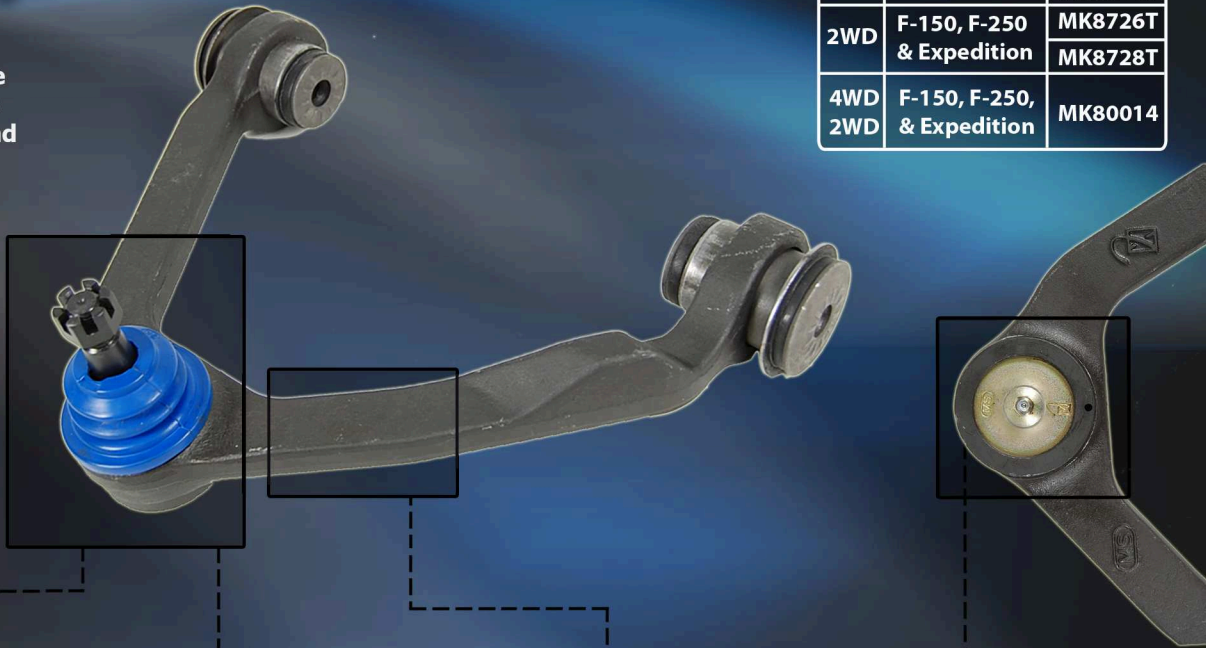

1.



2.



3a.



3b.

## Problems with OE

1. OE ball stud is small with soft material designed for plastic bearing.
2. Plastic Bearing susceptible to increased loading and compression failure.
3. Small Neck at ball joint prone to twisting and deformation of the ball joint socket.
4. Minimal grease is provided in the non greasable joint, leading to dry bearing failure. Ball joint is not removable.



1.



2.



3.



4.