



2020-2006 Ford F-250 SD & F-350 SD Pitman Arm to Sector Shaft Fastening Hardware

Brand	Supreme	Product	Pitman Arm	Date	September 2021
Part Number(s)	MS409122				

The OEM utilizes a 46 mm sector shaft nut to secure the pitman arm to the sector shaft on the applications below. The pitman arm to sector shaft is tapered and relies on a press fit, with the properly torqued nut providing compression between the two components and splines, ensuring no slippage occurs. **See Figure 1.**

Application(s)

2020-2006 Ford F-250 SD
2020-2006 Ford F-350 SD

The OEM requires this nut to be replaced once it is removed, due to degradation of the pre-applied dry adhesive and the high torque value required to achieve correct clamping force (350 lb-ft/475 N-m).

Reusing the old nut may cause it to “back off” and/or damage the splines on both the pitman arm and sector shaft due to slippage in the absence of the correct clamping force. The vehicle operator may also experience a “loose” steering feel.

When servicing the pitman arm, follow the recommendations below:

- Note the correct installation orientation of the pitman arm before removal
- Thoroughly clean all threads and splines on the sector shaft and inspect them for damage and/or an out-of-specification condition. If damage is determined, replace steering box.
- Only use a new nut to mate pitman arm to sector shaft
- Refer to factory service manual for correct torque values and procedures

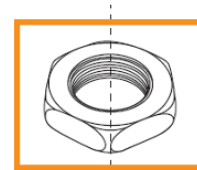
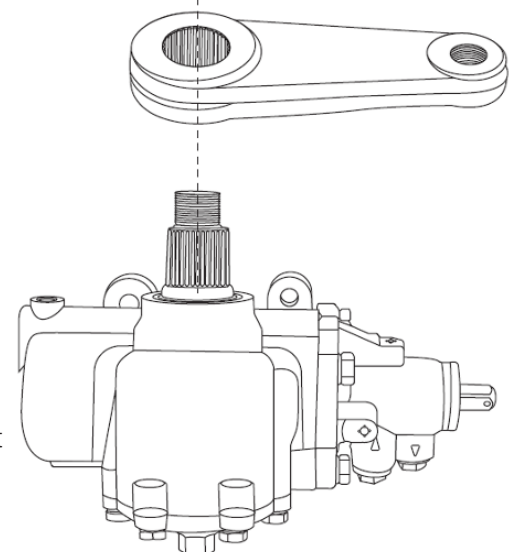

Figure 1. Nut (orange highlight left) must be replaced when servicing pitman arm



Always refer to the factory service manual for correct diagnostic procedures, component removal and installation methods, as well as fastening torque values and procedures where applicable. Only use a calibrated torque wrench for final fastening.

