



Axle Bolt Type Identification – BMW F-Chassis Vehicles

Brand	N/A	Product	N/A	Date	July 2021
Part Number(s)	Various				

When conducting a steering, suspension and/or wheel end repair on the application(s) below requiring removal of the axle bolt, it is critical that the bolt be replaced with new hardware. These application(s) use a spur gear design, particularly on the front axle, compared to a conventional splined wheel hub and axle mating interface.

This bolt not only maintains correct fit of the spur gear between the axle and hub but also manages proper tension via a compression spring. It is considered a torque-to-yield (TTY) fastener. To aid in identification of this bolt type, **see Figure 1**.

Application(s)	
BMW	2 Series (F Chassis)
BMW	3 Series (F Chassis)
BMW	4 Series (F Chassis)
BMW	5 Series (F Chassis)
BMW	6 Series (F Chassis)
BMW	7 Series (F Chassis)
BMW	X1 (F Chassis)
BMW	X2 (F Chassis)
BMW	X3 (F Chassis)
BMW	X4 (F Chassis)

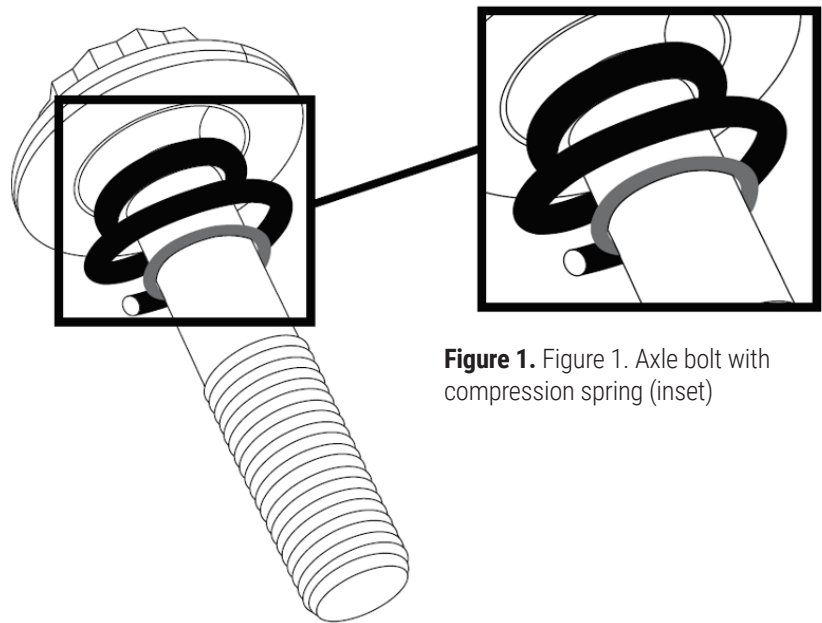

Figure 1. Figure 1. Axle bolt with compression spring (inset)

Always refer to the factory service manual for correct diagnostic procedures, component removal and installation methods, as well as fastening torque values and procedures where applicable. Only use a calibrated torque wrench for final fastening.

