



Proper ABS Magnetic Encoder Ring Orientation

Brand	BXT	Product	Bearings with Integrated Ring	Date	June 2020
Part Number(s)	Various				

Issue: Correct Magnetic Encoder Ring (ABS Tone Ring) Orientation

Certain Generation 1 bearing types feature an integrated Magnetic Encoder Ring or ABS Tone Ring. This is characterized by one of the two external seals functioning as the Ring.

It is important that these bearing types are installed in the proper orientation. The seal with the integrated Ring must be installed closest to the ABS sensor. Failure to do so will lead to the improper operation of a vehicle's ABS system. Additionally, removing a bearing with an incorrectly installed (backward/wrong way around) Ring may lead to damage to the Ring or bearing assembly.

Solution

- Determine side with integrated Ring. This can be achieved via:
 - Close visual inspection. A window pattern may be visible on the side with the integrated Ring.
 - Using a small metallic item. The metallic item will be attracted to the side with integrated Ring. Do not use any item with a strong magnetic field.
 - Using a Magnetic Encoder Ring Test Card.
- Exercise caution and care during handling and installation to prevent damage to the seal with the integrated Ring.
- Ensure side with integrated Ring is installed closest to ABS sensor.

By following this procedure, bearings with an integrated Ring will be installed in the correct orientation, ensuring the proper function of the ABS system.

Figure 1

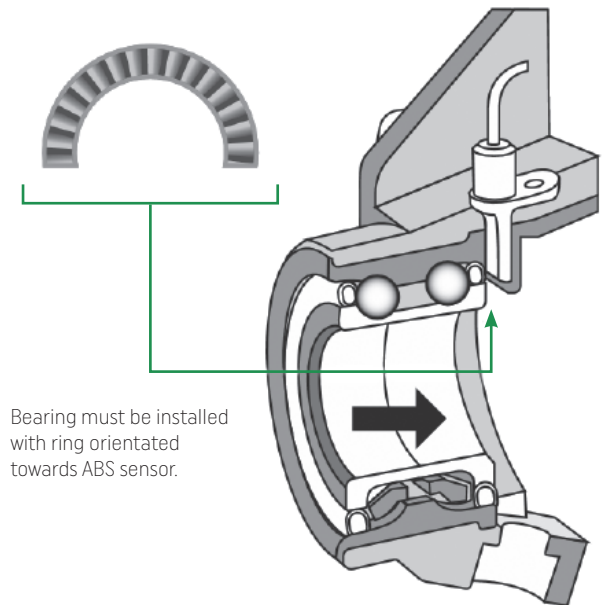

Bearing must be installed with ring orientated towards ABS sensor.

