



Major LaborSaver™: Infiniti G35 AWD Front Lower Forward Control Arms

Brand	Supreme	Product	Control Arms	Date	April 2021
Part Number(s)	CMS301022/CMS301023				

The OEM (PN#s: 54501AL801 and 54500AL801) and other OE-style front lower control arms for the below listed application(s) do not incorporate a pre-fitted ball joint.

Application

2005-2006 Infiniti G35 AWD

Mevotech Supreme front lower control arms CMS301022 and CMS301023 incorporate a pre-fitted ball joint, reducing installation time and provide an enhanced value repair option. Additionally, the ball joint is characterized by a greaseable self-lubricating sintered metal bearing for increased part service life. New hardware, including a sleeve, is included for a complete install. **See Figure 1.**

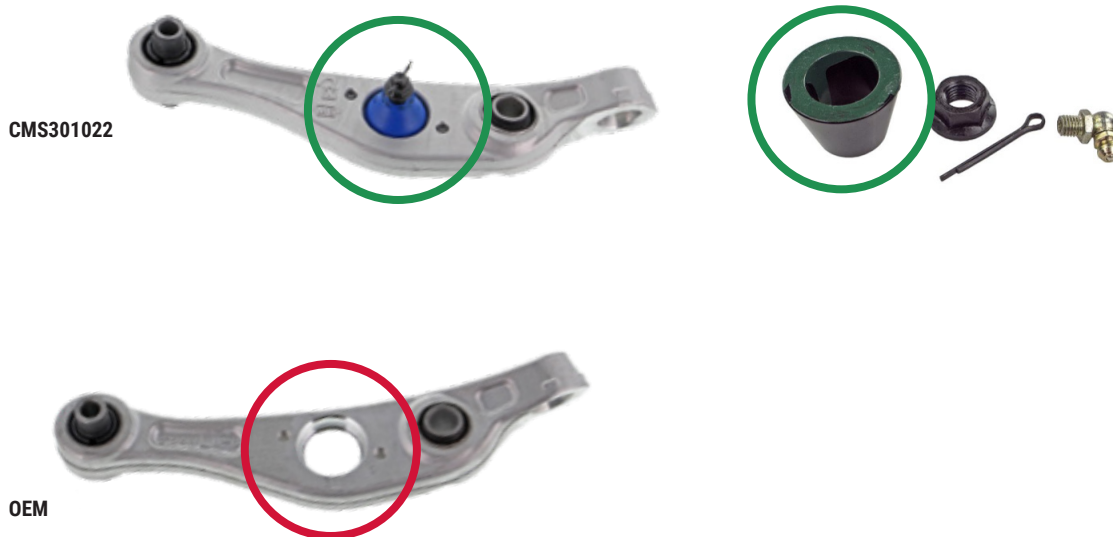

Figure 1. Mevotech Supreme control arm with pre-fitted ball joint and hardware with sleeve (top) vs bare OEM-style control arm (bottom)

