



## 2022-2010 Toyota & Lexus SUV Front Lower Control Arm KDSS Identification

Brand	Supreme	Product	Control Arm	Date	July 2022
<b>Part Number(s)</b>	CMS861082/CMS861083				

Depending on factory-equipped ride and handling package, the below noted applications may be equipped with the Kinetic Dynamic Suspension System (KDSS).

**Application(s)**

- 2021-2010 Lexus GX640
- 2022-2010 Toyota 4Runner
- 2014-2010 Toyota FJ Cruiser

To enhance compatibility, reduce installation time and provide more value in a repair option, Mevotech Supreme replacement front lower control arm assemblies CMS861082 and CMS861083 include a new stabilizer bar bushing, stabilizer bar bushing bracket and bracket mounting hardware for use with KDSS-equipped vehicles. **See Figure 1 and 2.**

It is important to note that the control arm assembly itself will fit both KDSS and non-KDSS equipped vehicles.

These additional components are for use with KDSS-equipped vehicles only. Do not attempt to install these additional components on a non-KDSS equipped vehicle. Verify suspension type before installation.

**Figure 1.**



**Figure 1.** Mevotech Supreme front lower control arm assembly CMS861082 with additional components for KDSS-equipped vehicles (circled)

**Figure 2.**

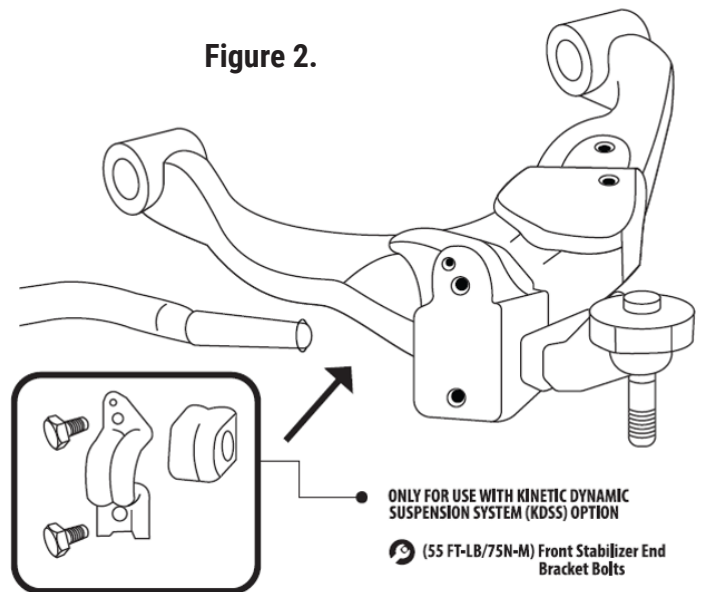

**Figure 2.** KDSS-equipped vehicles feature a mounting area on the control arm for the stabilizer bar

