



IMPORT VEHICLE CONTROL ARM REPAIR SOLUTIONS



GS101366 /GS101367
Front L/R Upper
2019-2016 Mercedes-Benz GLE Class



GS861300 /GS861301
Front L/R Lower
2024-2018 Toyota Camry



GS901293 /GS901294
Front L/R Lower
2024-2021 Hyundai Sante Fe
including Hybrid



Fastening Hardware Included

Introducing more import vehicle nameplate coverage with the Mevotech Original Grade™ control arms program!

- Precision designed, tested and built to exact tolerances for optimized long-life performance.
- Install advantages which reduce fitting time and provide more value out of the box.
- Wide-ranging coverage means a broad catalog of replacement control arms, including for Import vehicles based on Hybrid and Electric drivetrains.

MEVOTECH



EXACT MATCH FOR
ORIGINAL EQUIPMENT

IMPORT VEHICLE CONTROL ARM REPAIR SOLUTIONS



DESIGNED FOR LONG SERVICE LIFE

Constructed for durable and trouble-free performance. Restores original vehicle handling and ride characteristics.

Anti-corrosion coating
protects assembly
components against rust.

Resilient boot
material protects
against road debris.

Vehicle-specific fastening
hardware included*

Bushings are optimized for
longevity and a quiet ride.

Constructed using
techniques and materials
to match the original.

*where applicable



FASTER FITTING TIME

Vehicle-specific enhancements reduce install time and provide increased value out of the box, compared to OEM.

PRE-INSTALLED BALL JOINT

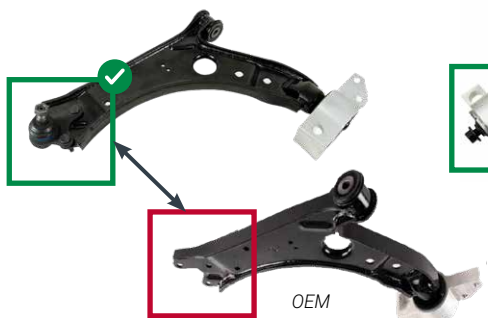

GS101147/GS101148
Front L/R Lower
2014-2006 Volkswagen Jetta

PRE-INSTALLED BUSHING

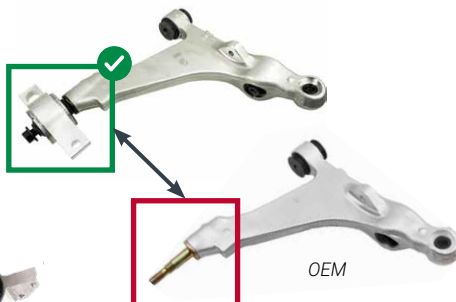

GS861132/GS861133
Front L/R Lower
2020-2006 Lexus IS Class

FASTENING HARDWARE

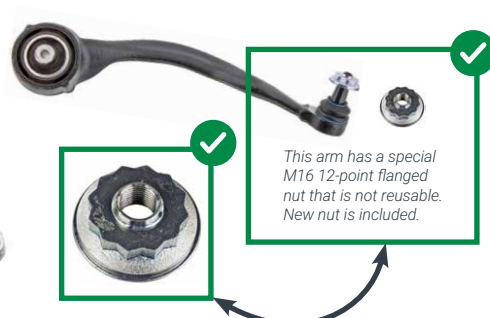

GS101483/GS101484
Front L/R Lower Forward
2022-2017 Land Rover Discovery



WIDE STEERING, SUSPENSION AND WHEEL BEARING IMPORT COVERAGE

Use Original Grade replacement components for a full suite of repair solutions on Import vehicles. Mevotech Original Grade parts meet and exceed OE design specifications for fit, form and function, renewing fatigued chassis systems and keeping vehicles on the road longer.



GS60525
Front Lower Ball Joint
2024-2016 Honda Civic



GS30667/GS30668
Front L/R Outer Tie Rod End
2023-2013 Nissan Altima



GS70841
Front Stabilizer Bar Link
2018-2012 Audi A6 Quattro



G80304
Rear Wheel Bearing Assembly
2023-2012 Subaru Impreza

ENGINEERED FOR TECHNICIANS

Customer Care: 1.866.883.7075 | Tech Hotline: 1.844.572.1304

MEVOTECH.COM